

dla G2 100mm 1000lm



RANGE	TRIDONIC LED MODULE AC
REF.	TR2800224-
TYPE	DOWNLIGHT
DIMENSIONS	ø114 x 77 mm
FREE HEIGHT FOR INSTALLATION	100 mm
WEIGHT	0,193kg
FINISH	BLUE AND WHITE
VOLTAGE	220 - 240 V
FREQUENCY	50 / 60 Hz
FEEDER KIT	INCLUDED
DIMMABLE	NO
POWER	10,2 W
POWER FACTOR	0,9
SERVICE LIFE	50.000h (L70)
IP RATING	IP20
OPERATING TEMPERATURE	-20 a 40 °C
LIGHTING DISTRIBUTION	DIRECT
COLOR TEMPERATURE	3000 K / 4000 K
CRI	80
MACADAM ELLIPSE	4
LIGHTING FLUX	1060 lm / 1110 lm
LUMINOUS EFFICACY	103,9 lm/w / 108,8 lm/w
OPENING DEGREES	60° / 90°



CODE	DESCRIPTION
TR28002241	DLA G2 100mm 1000lm 830 SNC EM MOD
TR28002242	DLA G2 100mm 1000lm 840 SNC EM MOD

dla components

DRIVER	DESCRIPTION
TR28002236	DLA G2 100mm 1000lm 8x0 SNC EM ECG

REFLECTOR	DESCRIPTION
TR28002190	ACD REFLECTOR G2 100mm 60D
TR28002191	ACD REFLECTOR G2 100mm 90D

*Choose one reflector

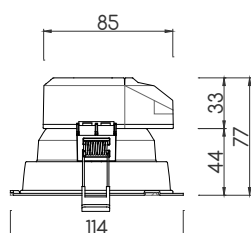

dla^{acc}

CODE	DESCRIPTION
RINGDLARO13400	RING DLA round 134mm white
RINGDLASQ13400	RING DLA square 134mm white